

# RIVERVIEW MUSIC DISTRICT: Community Scale

Cyrus Beasley, Faustyn Pavicich, Greg Wheeler, Jasmine Morrow, Lauren Burton, Phil Timmons

## PROJECT FEATURES

The Music District houses many different types of music venues linked to each other with lively pedestrian movement, and street musicians on streets and to the public plaza on the river. The existing network of sidewalks and railroad areas on Broadway and along the riverfront area will be transformed to a unified district design that incorporates both night and daytime activities in all seasons. Along Broadway and 2nd Street, bus and light rail stops would include hosted restrooms and in the cold months, warming areas. On the parkland along the river from the existing Overlook to Broadway, will be a boardwalk that connects the community center to beach access, fishing areas and boat launch and rental so that allow people can participate in river-oriented activities.



WEST BROADWAY COMPLETE STREET RENDERING



PROPOSED MUSIC DISTRICT EXTENTS

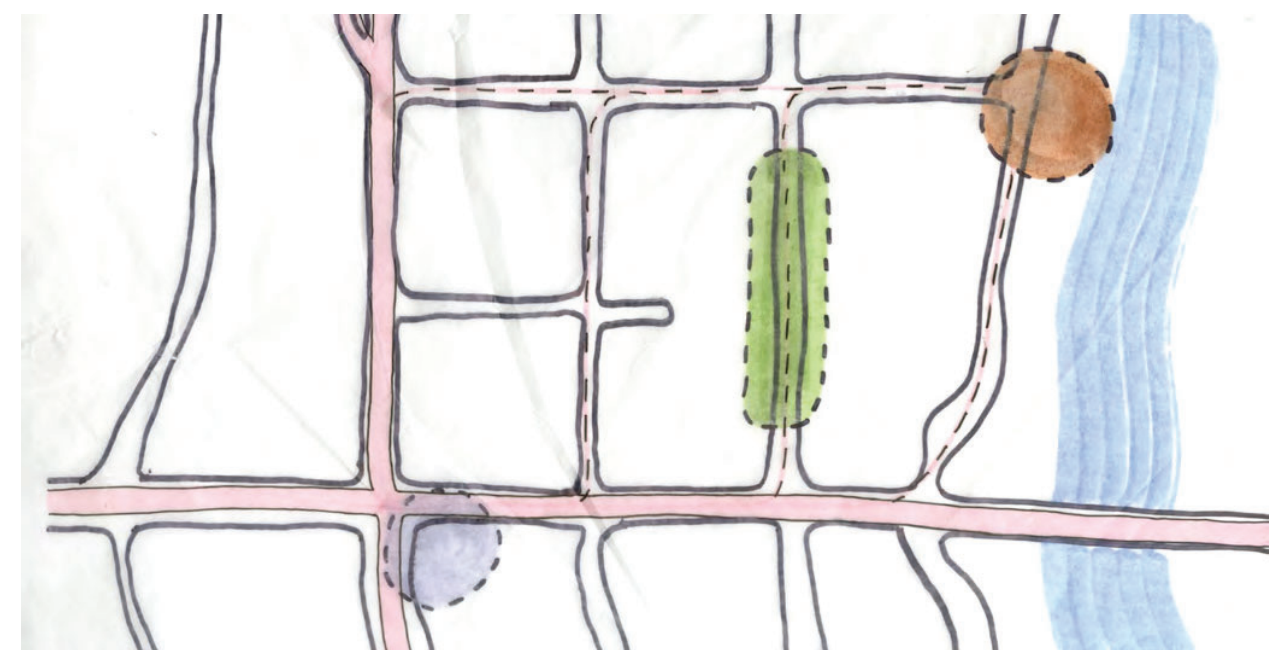

MUSIC DISTRICT SITE DIAGRAM

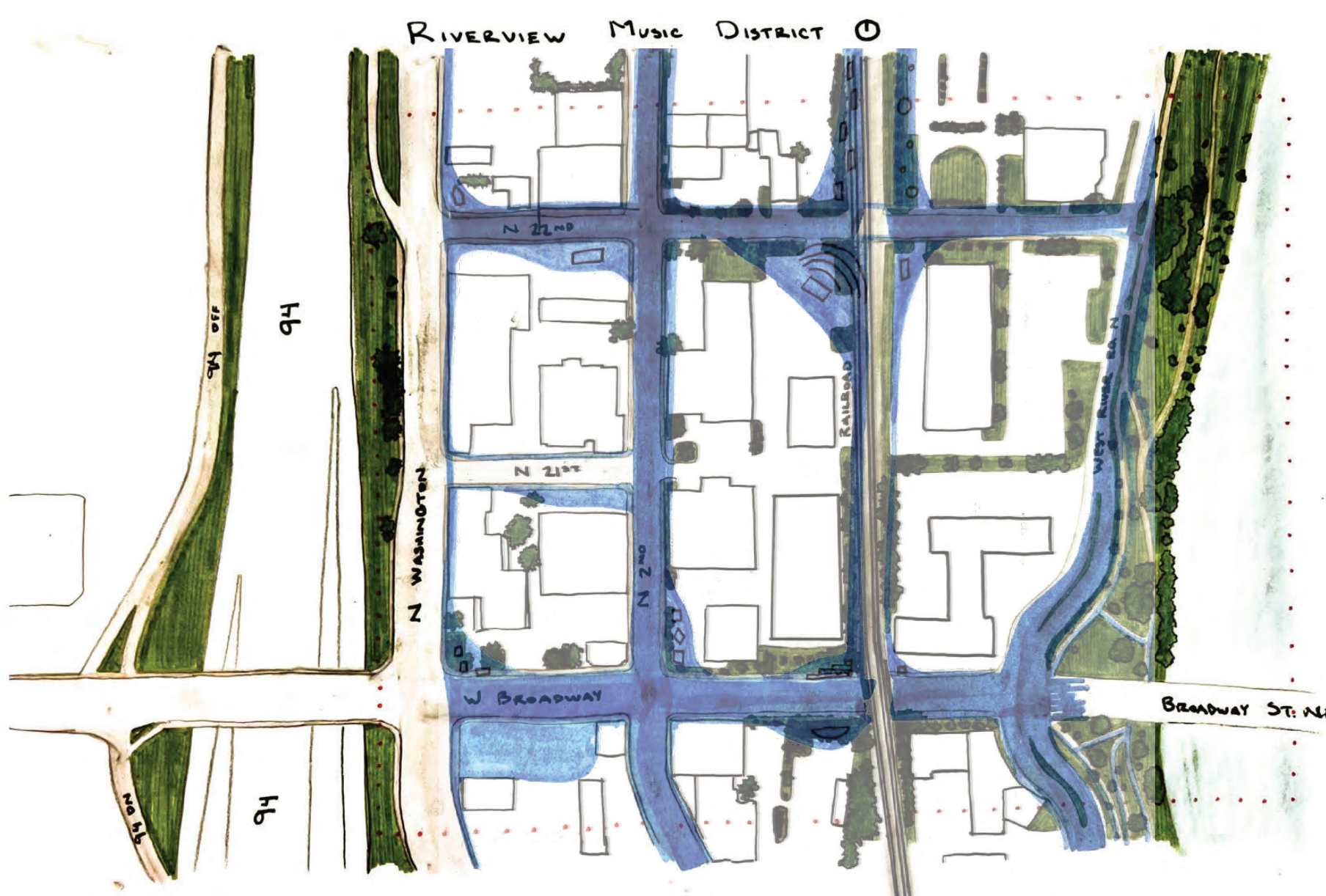

PARKS + PEDESTRIAN STREET SITE PLAN

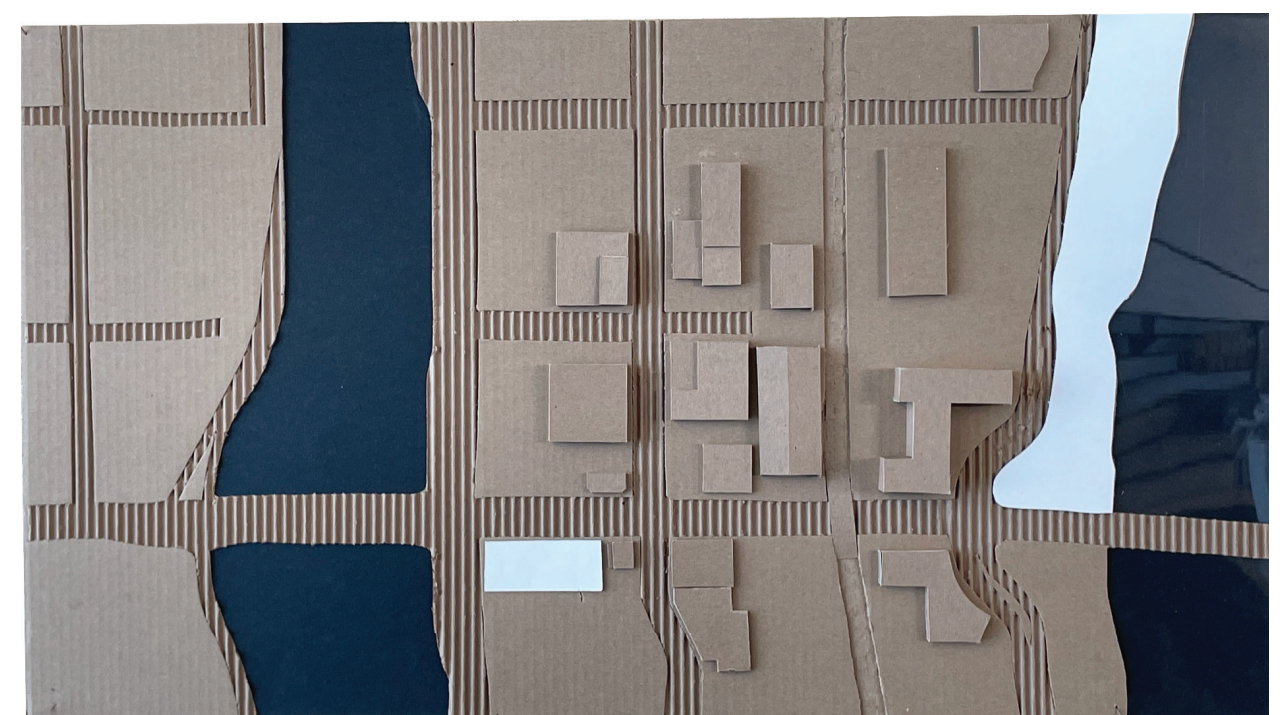

MUSIC DISTRICT MODEL

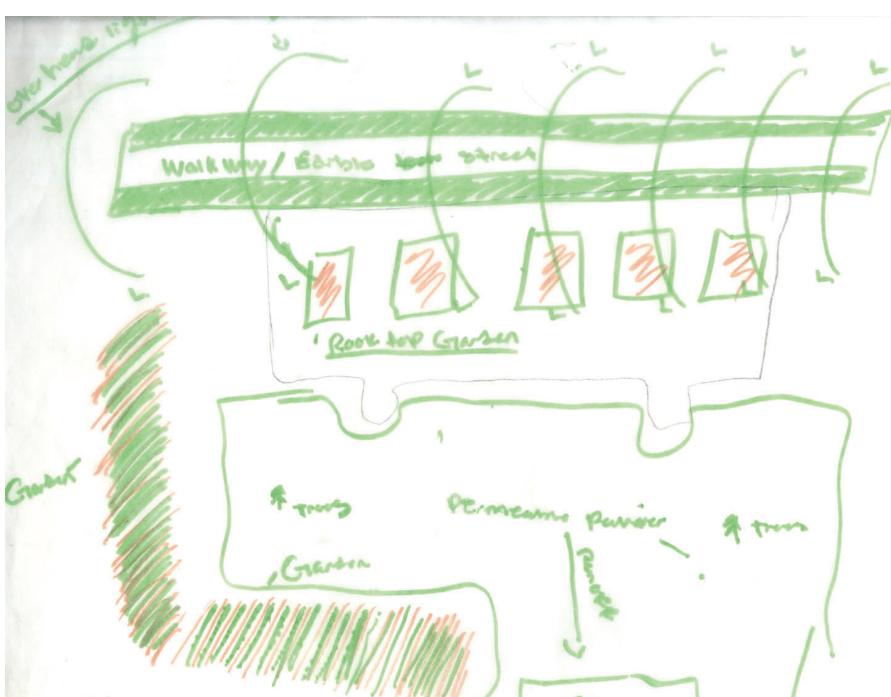

EDIBLE RAILWAY SKETCH

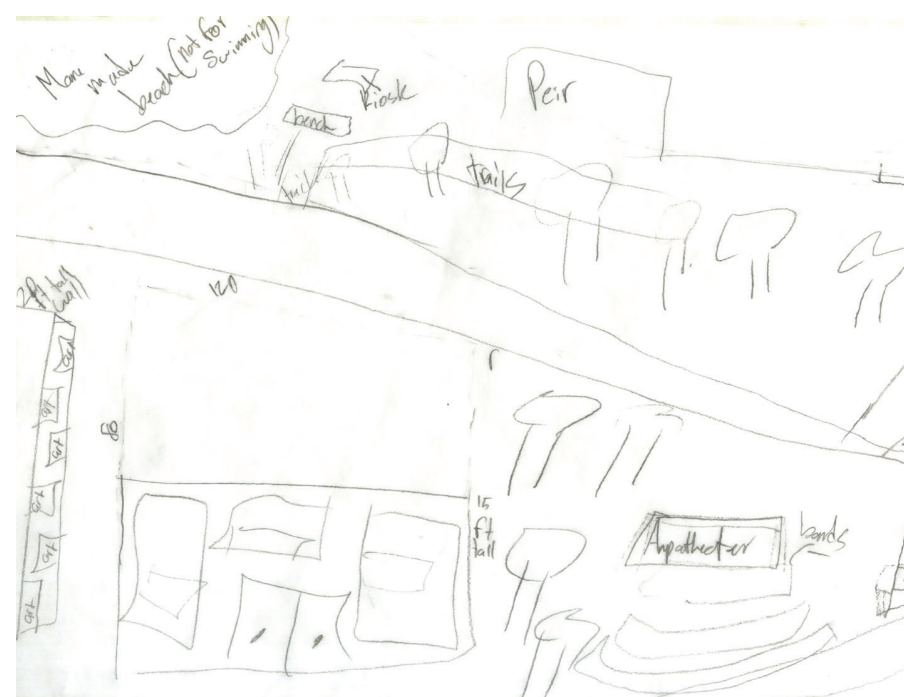

MUSIC VENUE SKETCH

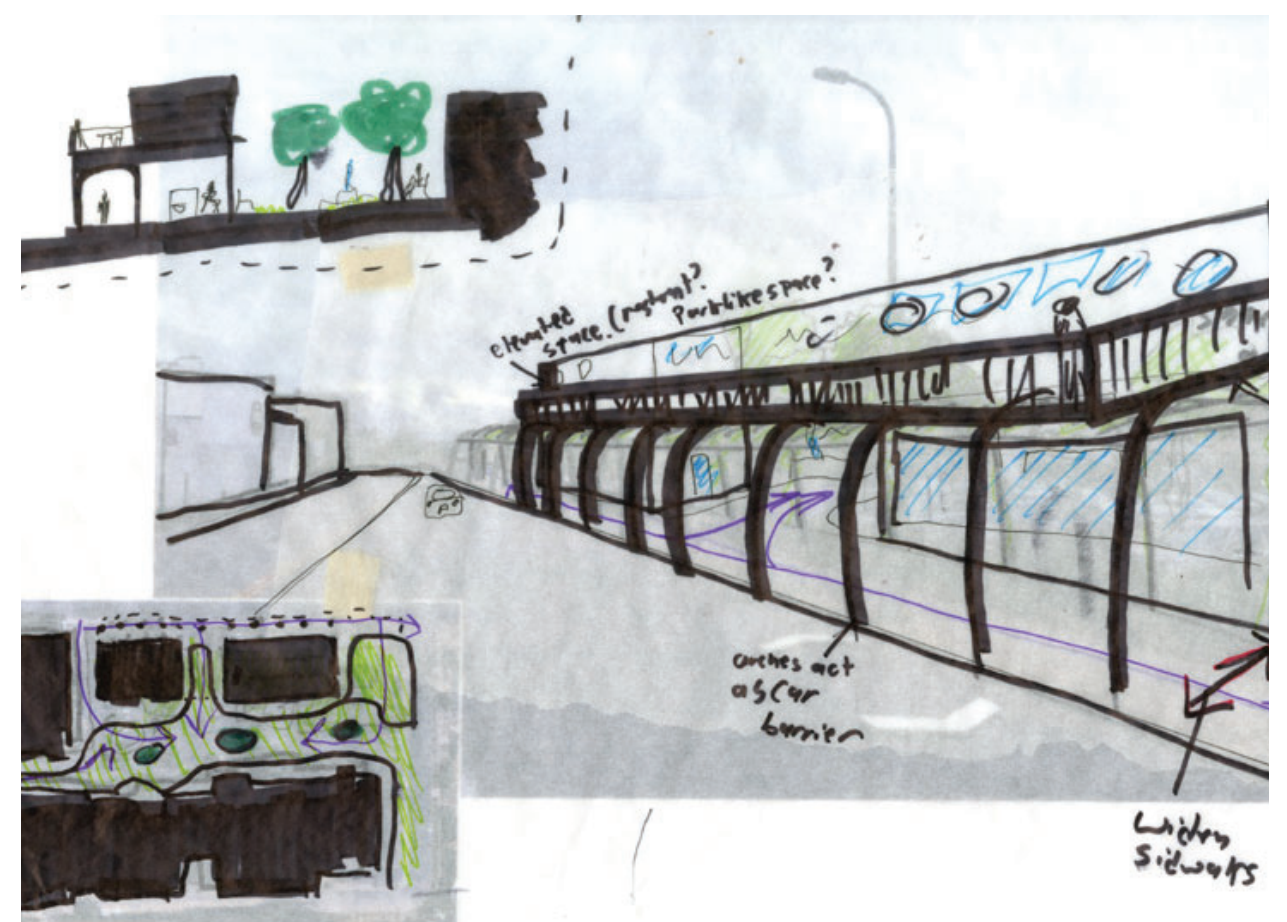

WALK + BIKE CONNECTION SKETCHES